

# WATER CASTLE TAMAN SARI

*(click the picture for more information)*



Map of taman sari



Entry gate of castle



The front yard of castle



the exit from the pool



Bathing pool for the Queen



the exit gate of castle

# Map of Taman Sari

In different locations:

- Near the entrance
- In front of information room
- In front of the fountain



# Near the entrance



# In front of information room



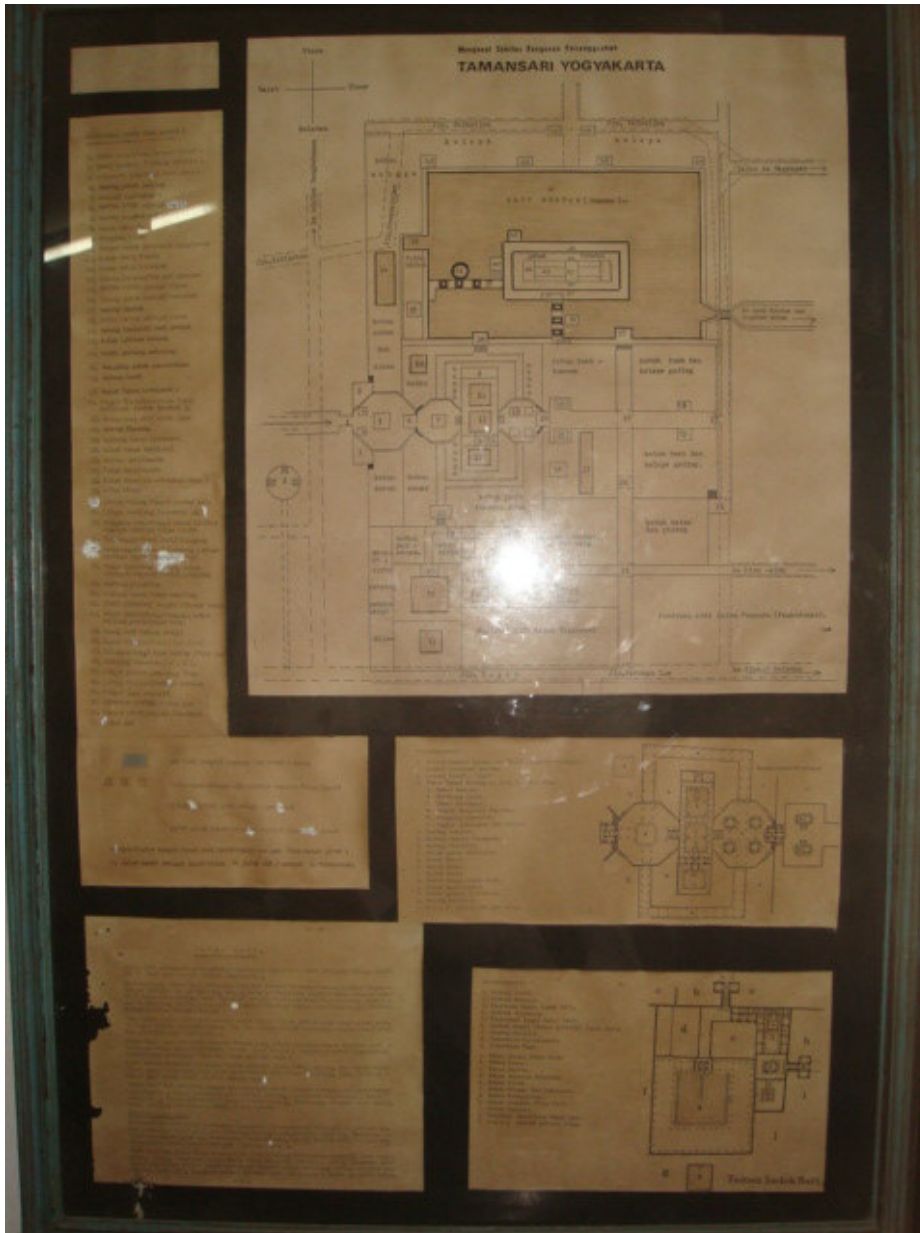

**In front of the fountain**



# Outside of the castle

what is in the front of the castle??

the answers are...



# Entrance of Taman Sari



# The Entrance Gate





# The Front Yard

it is a beautiful place located inside the castle before you get to the pool.

there is an entrance gate to the pool at the end of the yard.



# Here is the entrance yard!



# This is the entrance to the pool



There are some visitors walked around  
The pool



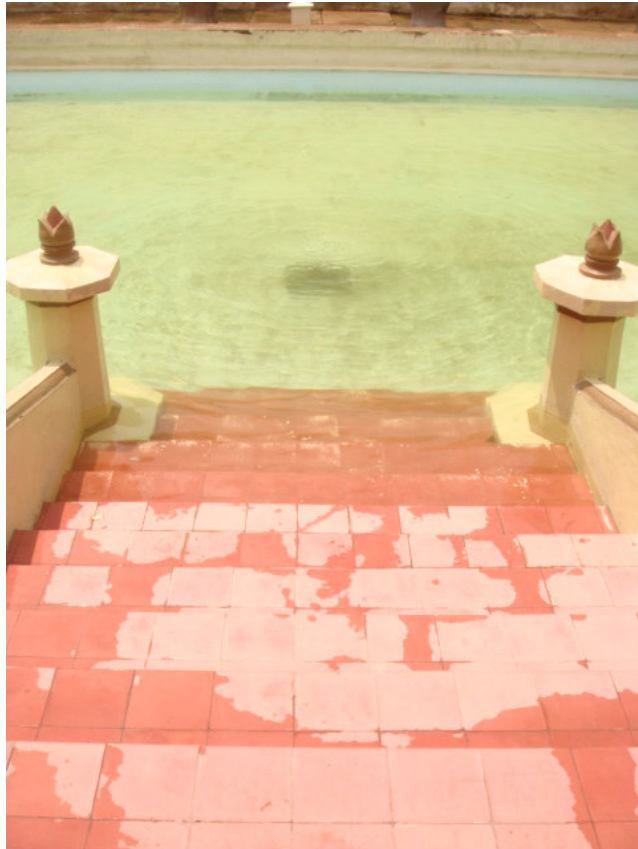

We are interviewing a visitor  
At the stairs.



# The Bathing pool for the Queen

There are some unique places around the pool:

- A tower
- Sultan's bed
- Stairs of the tower



# The Bathing pool for the Queen



**Ground view**



**Upper view**



# The Exit Gate

Around the exit gate, there are:

- Batik Makers
- Artists (painters)
- Craftermans
- Houses





**The exit gate**



**Batik maker**



**One of the houses**







**Donation for maintenance**



**The Sultan's Bed**



**Sign to keep clean the area**



**The under water mosque**



***In the end***



***That was all of our work, and here is  
our team members: (from left to right)***

***Ali, Sahid, Taufiq, Adit and Robi***

